

# Arrestor

The Best Wireless Solution!

## N F \* F B.H. Gas tube Arrestor

P.N. : G02-G0102-01

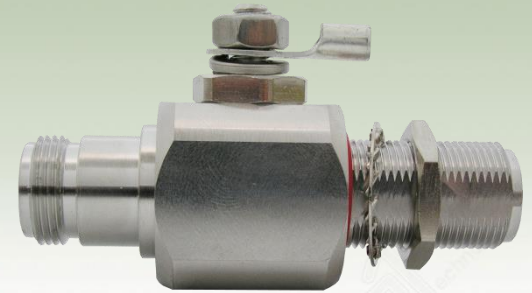

### Electrical specification

Item	Specification
Frequency range	DC ~ 3 GHz
Impedance (Nominal)	50Ω
V.S.W.R (max)	1.20 : 1
Insertion Loss (max)	0.25 dB( DC ~ 2.5GHz ) 0.3 dB ( 2.5 ~ 3.0GHz )
SURGE CAPABILITY (Nominal)	10KA (8X20μs)
Connector type	N female – N female
RoHS	Compliance

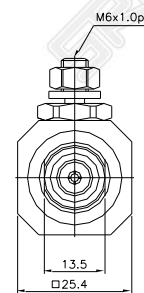
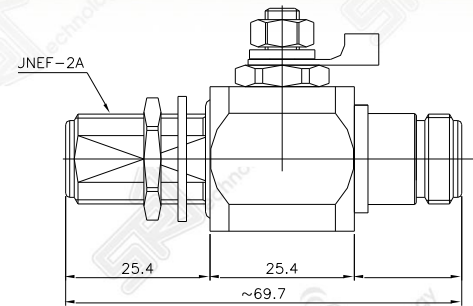

### Material specification

Item	Specification
Body	Brass / Tri-Alloy plating
Center contact (pin)	Brass, Be-cu / Gold plating
Insulator	PTFE

### Electrical performance

